



NEW PRODUCT BULLETIN # 350

1641 HUB

DESCRIPTION: 6 Stud Hub w/8.75 Dia. Bolt Circle
Uses Rotor - 3/4-16 Stud

TRUCK STEERING AXLE APPLICATIONS
WEBB AXLE GROUP 28

Dana Spicer (Eaton): S-135, S-150

Bearing Information (Webb Axle Group # 28)

Outer Bearing Cup	39520	←	Cup Code 1
Cone	39585		
Inner Bearing Cup	33462	←	
Cone	33287		

Wt: 49 LBS
(Hub, Cups, Studs for Steel Disc Wheels)

Specification Information

Drawing Reference	Item	Dimension
B	Overall Length	8.84
C	Outer Hubcap Face to Inner Brg. Cup Seat	5.76
D	Distance Between Cups	3.38
E	Inner Cup to Mounting Face	.74
F	Bolt Circle Diameter	8.75
G	Wheel Stud Qty./Thread Diameter	(6) 3/4-16
H	Hub Cap Hole Pattern	8 studs @ .56
	(Hub Cap Not Available From Webb Wheel)	6.75 Bolt Circle

Hub Dynamic Capacity: 7,750 lbs.

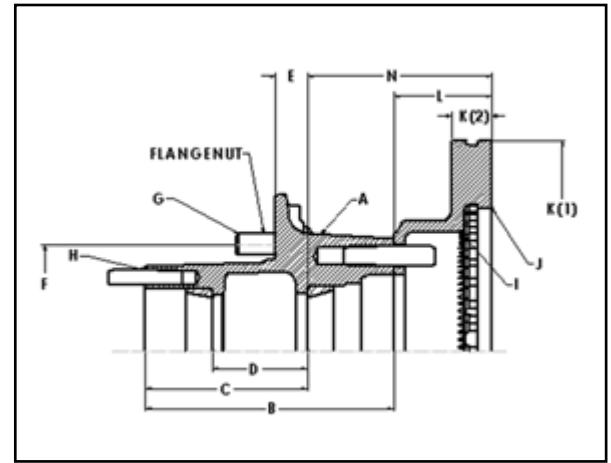

Assembly Drawing

I. ABS

Part Number: Rotor has ABS Teeth
Pitch Diameter: 8.96
Cup Seat to ABS Face Dimension: 5.61

Rotor Information

Drawing Reference - ROTOR ORDERED SEPARATELY

J			Special Information	K		L	M	N
Part No.	Rotor Order Code	Est Wt.		Rotor Size (1) Dia.	Rotor Size (2) Width	Rotor Overall Depth	Rotor Bolt Circle	Cup to End of Rotor
54770P-65		41	ABS Rotor	15.00	1.435	3.50	6.75	6.58

Wheel Fastener Information

CHECK DISC WHEEL THICKNESS BEFORE ORDERING

Disc Wheel	Tire App.	Rotor Type	Stud (RH)	Stud (LH)	Flange Nut	Stud Stand Out	Order Code For Flange Nuts Less
Steel/Alum	Dual	Hat	159190	159191	n/a	1.38	M

SPECIAL NOTES

This hub designed for dual wheel mounting or single wheels with 1/2" maximum offset.

This hub will replace Webb hub 1941F.